

THE NEW TWO STORY PROTOTYPE ELEMENTARY SCHOOL REPLACES THE EXISTING SCHOOL FACILITY ON THE SAME SITE.

PROJECT DATA

- TOTAL PROJECT COST:** \$22,148,750
- BUILDING AREA:** 94,000 SF
- GRADE SPAN:** PRE K - 5
- STUDENT POPULATION:** 550 - 600
- COMPLETION DATE:** AUGUST 2011

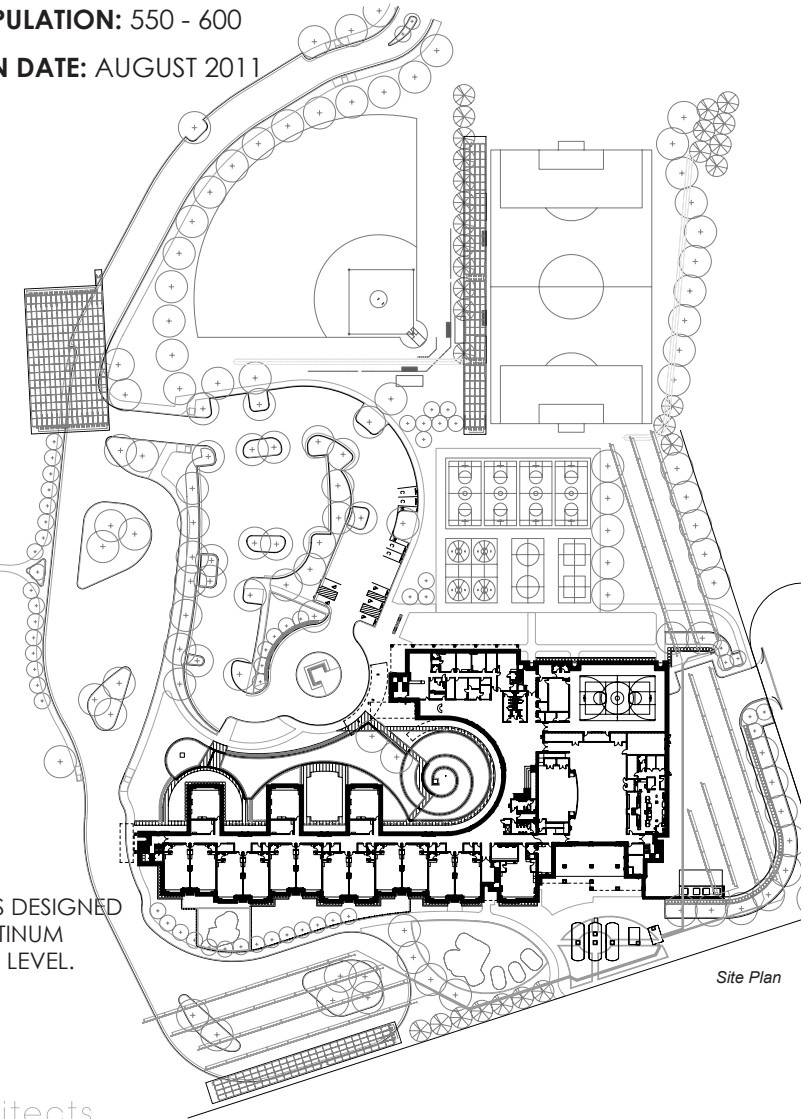

Site Plan

THE PROJECT IS DESIGNED TO A LEED PLATINUM CERTIFICATION LEVEL.



COLLEGE PARK ELEMENTARY SCHOOL



COLLEGE PARK ELEMENTARY SCHOOL



View on approach



View at entry

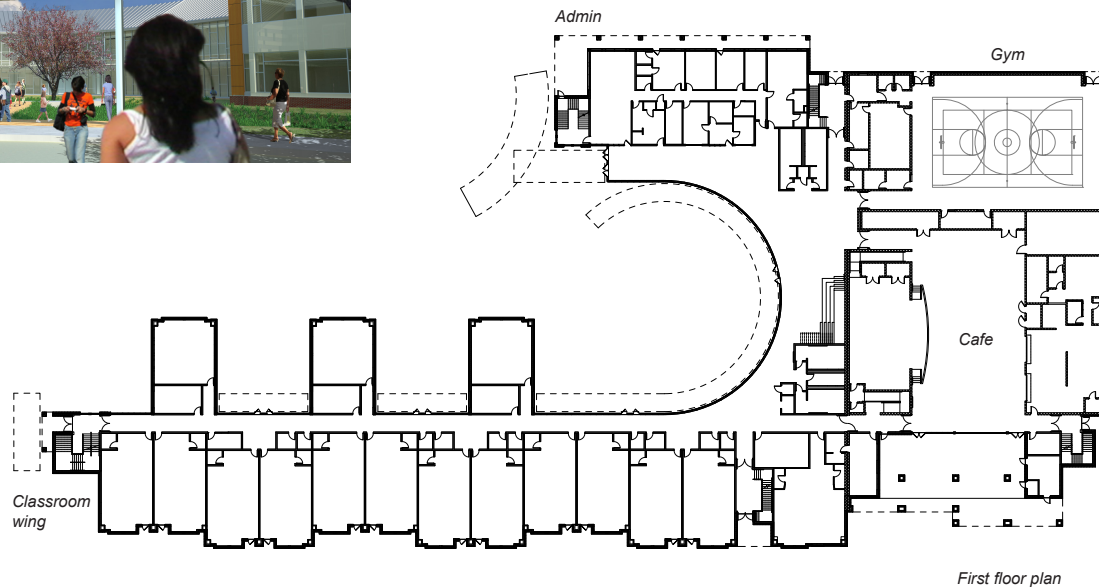

SUSTAINABLE FEATURES:



SOLAR THERMAL IN-FLOOR RADIANT HEATING AT PUBLIC SPACES, CAFETERIA, GYM, AND HALLWAYS

GEOHERMAL HEATING AND COOLING WITH (110) 300' DEEP WELLS

RAINWATER HARVESTING SYSTEM WITH (3) 15,000 GALLON UNDERGROUND CISTERNS FOR USE IN TOILETS, GEOHERMAL SYSTEM, AND NON-POTABLE SOURCES

NET ZERO STORMWATER SITE - HANDLES ALL RAINWATER UP TO A 100 YEAR STORM

10,000 SF SEMI-INTENSIVE NATIVE GREEN ROOF AND ROOFTOP LEARNING AREA

OUTDOOR TEACHING DECKS AND WALKWAYS AT RAINGARDENS

SOLAR CONTROL, DAYLIGHT HARVESTING/DIMMING, AND OCCUPANT SENSORS

SOLAR REFLECTANT ROOFING AND PAVING

DAYLIGHT AND VIEWS FOR 95% OF SPACES

HIGH PERFORMANCE GLAZING AND ENVELOPE

50% ENERGY REDUCTION BEYOND CODE